

Product Code	
Tolerances	
Range	Tolerance
0 < 400	± 1
400 < 800	± 2
800 or above	± 3

- NOTES:-**
- All dimensions are in mm unless stated otherwise
  - All hollow sections manufactured by Tata Steel
    - Rails to be Celsius HBP 100 X 100 & Celsius HBP 80 X 80 as noted
    - All others to be Celsius 355
  - Other steel sections to be grades as noted
  - Stainless steel hexagonal head screws to be grade A4 class 80 to BS EN 3506-1 & BS EN ISO 4017. Plain washers to be BS EN ISO 7089. Spring washers to BS EN 4464. Steel washers to be galvanised to BS EN ISO 1461. Stainless steel washers to be grade A4.
  - Post to be vertical to within +/- 15 over 1000
  - Rails shall be set to give a smooth flowing line with a **minimum height of 1350 from top of concrete to top of top rail**
  - Post / rail connection brackets set to follow slope of rails
  - Parapet manufacture & installation shall only be carried out by companies approved & licensed by Tata Steel
  - All carbon steel material to be hot dipped galvanised after manufacture to BS EN ISO 1461
  - All plates to be grades as noted to BS EN 10025

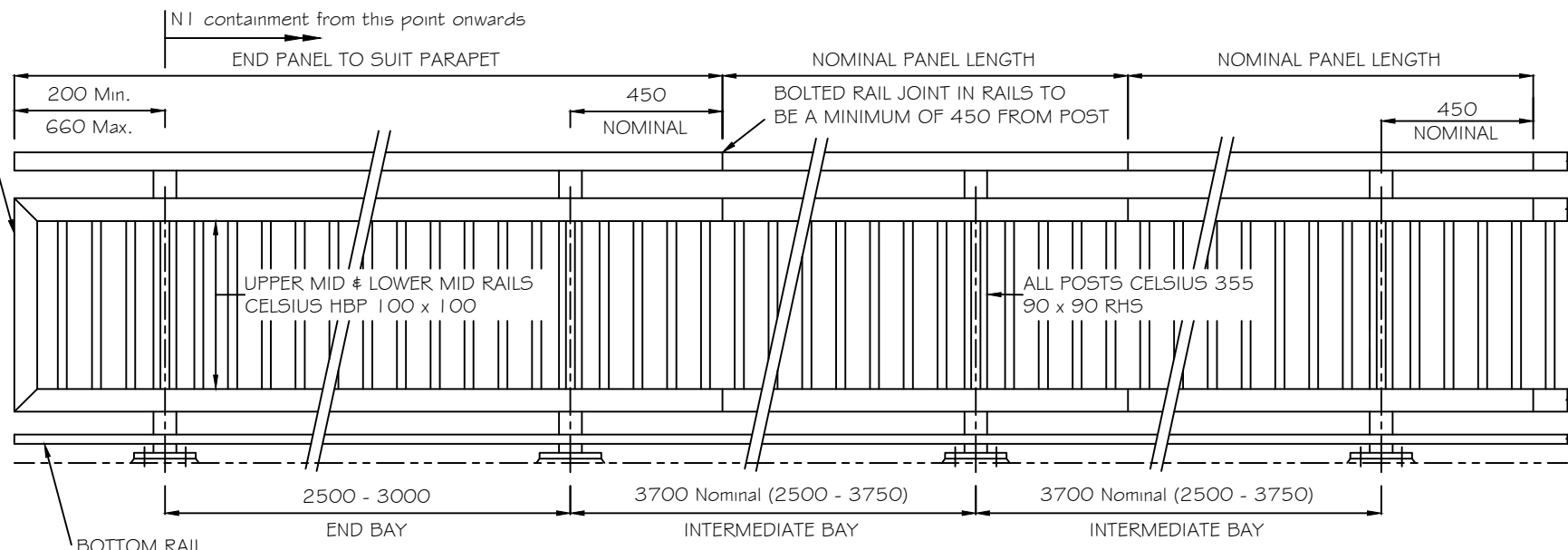

TYPICAL ELEVATION ON TRAFFIC FACE OF PARAPET

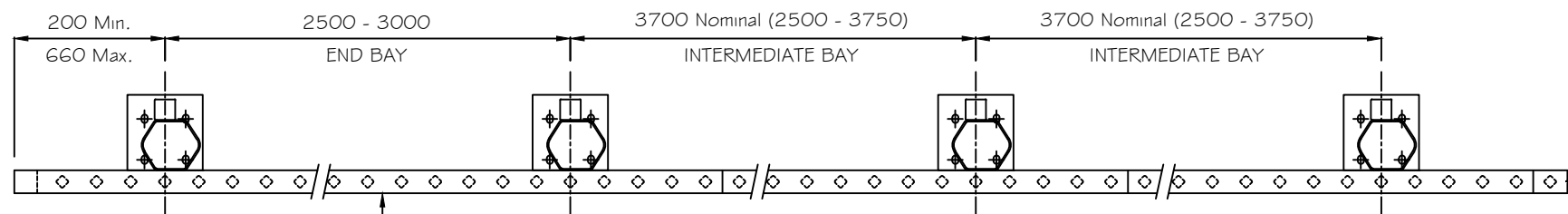

TYPICAL PLAN ON UPPER MID RAIL OF PARAPET

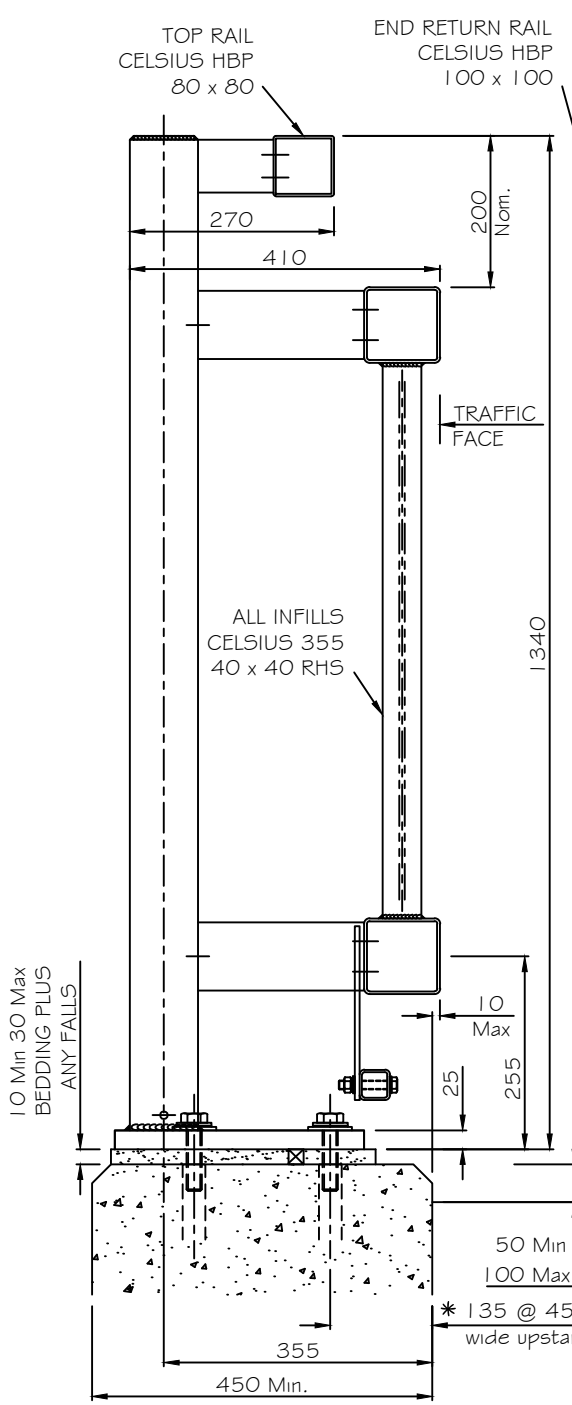

SECTION THROUGH PARAPET

POST ULTIMATE MOMENT CAPACITY TO ALL POSTS 14.1 kNm,  
COEXISTING SHEAR 21.8 kN,  
POST ULTIMATE SHEAR CAPACITY 131 kN

M20 ANCHORAGE BY TATA STEEL APPROVED SUPPLIER. ANCHOR BOLTS TO BE M20 HEXAGONAL HEAD STAINLESS STEEL SCREWS TO GRADE A4.80 COMPLETE WITH M20 FORM 'A' GRADE A4 STAINLESS STEEL WASHER, NYLON TOP HAT WASHER & M22 X 50 O/DIA X 4 THICK GALVANISED STEEL WASHER. NYLON TOP HAT WASHER TO BE FITTED ABOVE THE GALVANISED STEEL WASHER & BELOW THE STAINLESS STEEL WASHER & SCREW HEAD. ENGAGEMENT OF SCREWS INTO ANCHORAGE SOCKET TO BE IN ACCORDANCE WITH THE MANUFACTURERS STIPULATED REQUIREMENTS.

\* Dimension may be adjusted thus for alternative upstand widths:-  
135 for 450 wide upstand (as shown)  
145 for upstands 460 or greater

NOTE:-  
Cast-in anchor cradle may be substituted for HAPAS approved chemical anchors of appropriate size & load capacity where required by site conditions

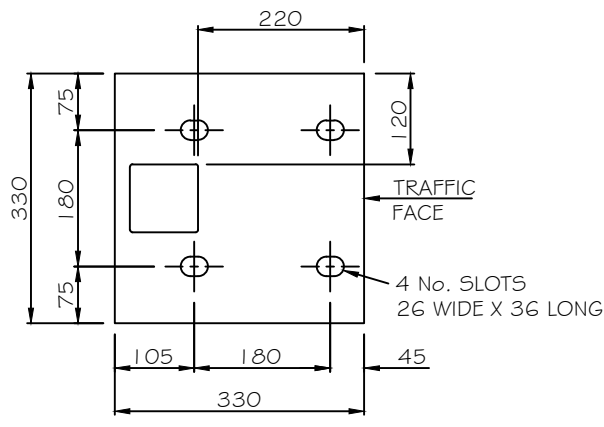

BASEPLATE DETAIL

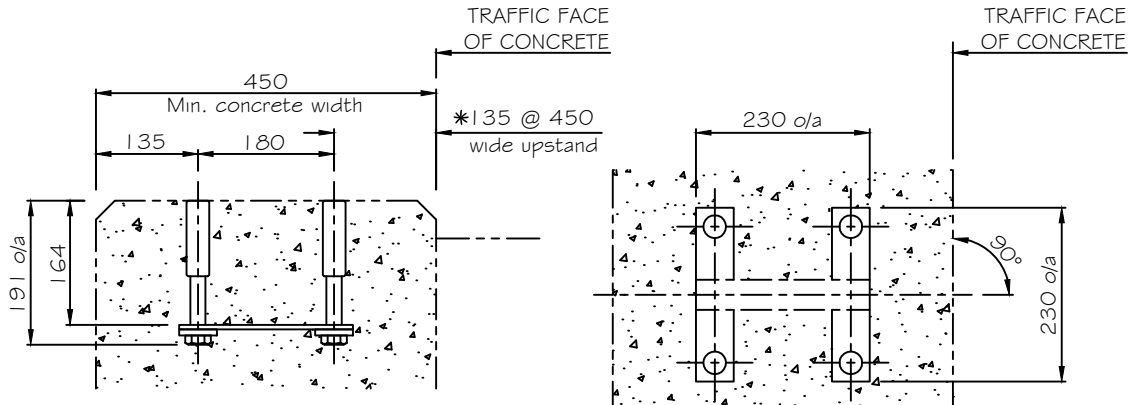

SECTION THROUGH UPSTAND

PLAN VIEW ON UPSTAND

ANCHOR CRADLE DETAIL

Anchor cradle shown: M20 55R170 as manufactured by Fixing Centre Ltd.  
(Alternative HAPAS approved anchor cradle of appropriate size & load capacity may also be used. Dimensions for alternative anchor to be checked with Fabricator)

01	Border updated	A.M.	S.C.S.	T.R.M.	Apr' 2012
00	Initial release	A.M.	T.R.M.	T.R.M.	Dec' 2009
Rev.	Description	By	Chk	App	Date

**TATA STEEL**

© Tata Steel - This drawing is the copyright work of Tata Steel. It may not be copied (in whole or in part) without the prior written consent of Tata Steel. The designs disclosed in this drawing may be the subject of other intellectual property rights and reproduction of the designs shown in this drawing without the prior written consent of Tata Steel may infringe intellectual property rights

email : cep.sales@tatasteel.com  
**Protect 365™ N1 Vehicle Parapet**  
80km/h car - Vertical infill  
1.4m nominal height (cycle way)

<b>P365/P/156</b>	Sheet 1	01
	of 1	