

TOLERANCE BOX		TOLERANCE	
RANGE		-	+
0 LESS THAN	400	- 0	+ 2.0
400 LESS THAN	800	- 0	+ 4.0
MORE THAN	800	- 0	+ 6.0

- NOTES:
1. POST EXTENSION MUST BE SUPPLIED COMPLETE WITH ITEM A237 OR A254. IT MUST NOT BE USED WITH ANY OTHER ITEM.
  2. REMOVE ALL BURRS AND SHARP EDGES.
  3. DURABLY MARK MANUFACTURERS IDENTIFICATION AND DATE (DAY MONTH & YEAR e.g. 21 08 2006).
  4. TOLERANCES STATED IN TOLERANCE BOX, EXCEPT WHERE OTHERWISE STATED.

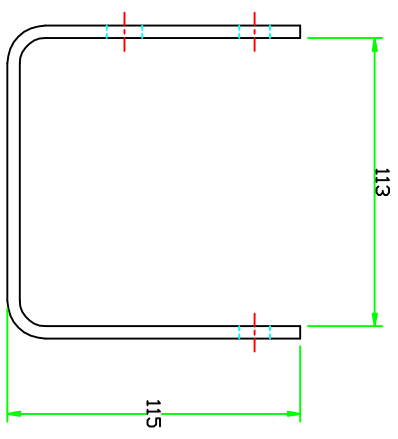
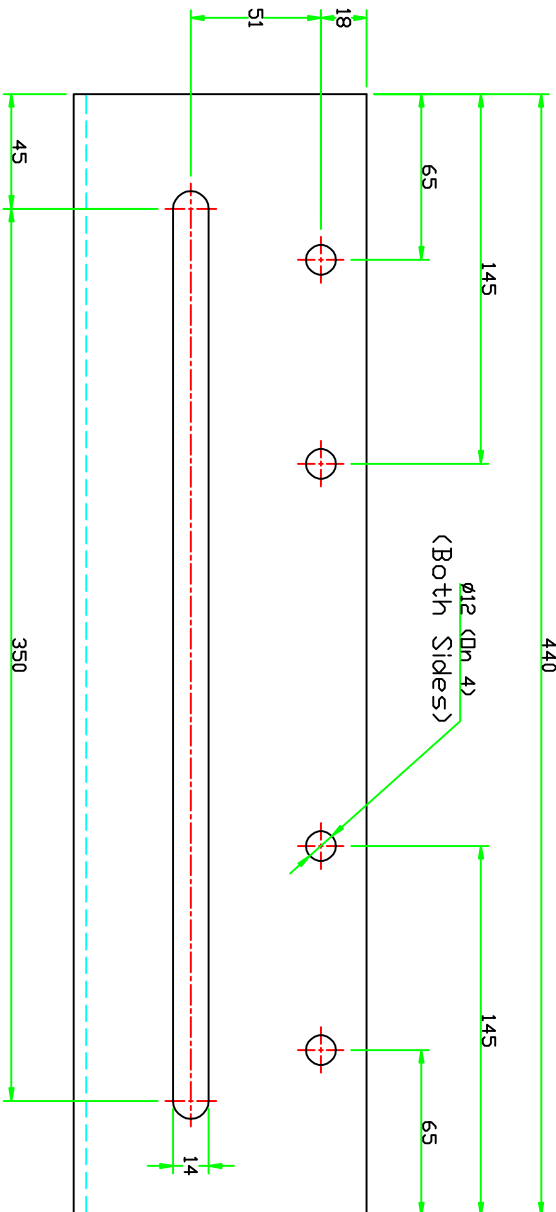
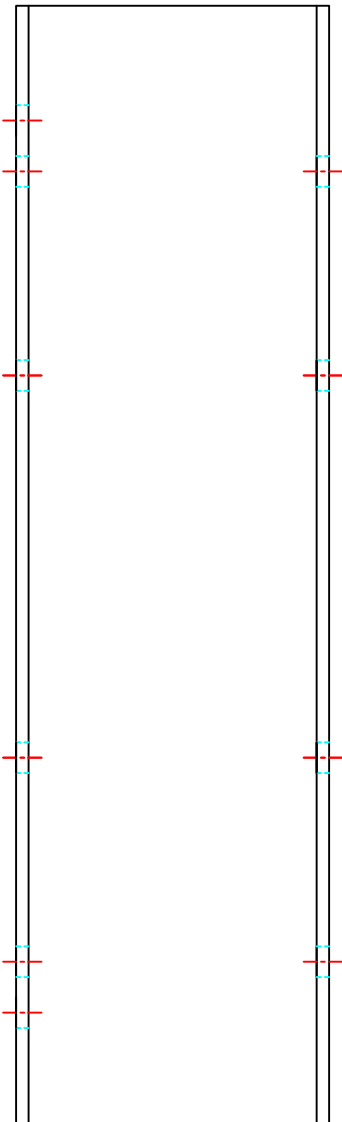

TYPICAL STAMP DETAIL

**VETEX A238 21 08 2006**



CORUS CEP, LLANWERN WORKS  
NEWPORT, S.WALES, UK, NP19 4QZ.

Sales tel: +44(0)1633 290011 Fax:+44 (0)1633 464508  
Technical tel: +44(0)1633 752100 Fax:+44 (0)1633 464508

**CORUS** email: [sales@corusgroup.com](mailto:sales@corusgroup.com)

Rev No	Revision Notes	Rev. Date	By
7	Drawing placed on new border	08/01/07	R.P
6	Drawing redrawn and renumbered	21/09/06	R.P
5	145 & 65 Dimensions were 175 & 95, A238 was A138	24/04/06	R.J

FINISH	MATERIAL	DESCRIPTION	POST EXTENSION	CUSTOMER	DATE DRAWN	SCALE	DRW. No.	Sh. REV.
GALVANISED				Vetex	21/09/2006	1:1	VC21C	1 7

**MODEL - A238**