

Corefast building core system

Typical design details

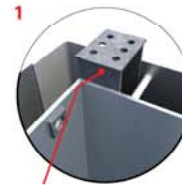

1 Stubs for incoming columns



2 Lifting hole with stiffener plate

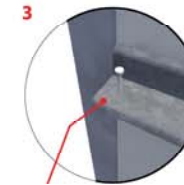

3 Shelf angles with shear studs attached as required

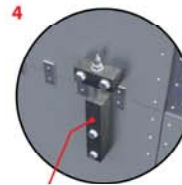

4 Corefast temporary adjuster assemblies allow vertical adjustment of Bi-Steel modules

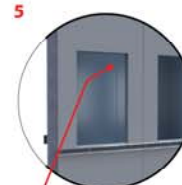

5 Door opening with 8mm closure plates to all faces

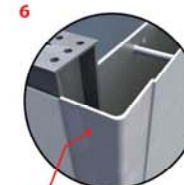

6 Pressed angle welded to 2 Bi-Steel panels to form corner module

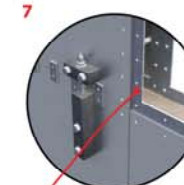

7 Modules are bolted together using splice plates

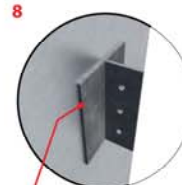

8 Welded T-fin plate (standard fin plates can also be used)



9 Rebar set into foundation (by others), centred between Bi-Steel connecting bars



10 Adjuster blocks provide vertical tolerance at foundation level



11 Angle weld to Bi-Steel panel to accept holding down bolt cast into foundation

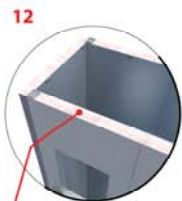

12 Once erected on-site, the Bi-Steel panels are filled with C40 grade pump-able mix concrete

Corus Bi-Steel
Crowthorne Enterprise Centre
Crowthorne Business Estate
Old Wokingham Rd
Crowthorne
Berkshire RG45 6AW

T + 44 (0) 1344 751 670
F + 44 (0) 1344 751 671
W www.corusconstruction.com/bi-steel
E bi-steel@corusgroup.com